



171279000-2023



Becker County Planning & Zoning  
915 Lake Ave  
Detroit Lakes, MN 56501  
(218) 846-7314  
www.co.becker.mn.us

## Certificate of Compliance

### Inspection Report - Permit #: SS2023-1694

#### Owner & Property Information

|                     |  |                            |  |
|---------------------|--|----------------------------|--|
| Owner Name:         | SHIRLEY A JOHNSON  | Site Address:              | 14546 TRADEWINDS RD                        |
| Mailing Address:    | SHIRLEY A JOHNSON<br>14546 TRADEWINDS RD<br>AUDUBON MN 56511 | Township -<br>Sec/Twp/Rng: | LAKE EUNICE - 07/138/042                   |
| Parcel #:           | 171279000  | Legal Description:         | TRADE WINDS BEACH LOT 33                   |
| Secondary Parcel #: |  | Designer:                  | Renner Excavating LLC, L2567 (Rick Renner) |
|                     |  | Installer:                 | Renner Excavating LLC, L2567 (Rick Renner) |

#### Inspector Verified Specifications

|                                  |     |                          |                      |
|----------------------------------|-----|--------------------------|----------------------|
| Insp- Effluent Screen Installed: | No  | Insp- Tank Nbr/Size:     | 1/2500               |
| Insp- Alarm Required:            | Yes | Insp- Drainfield Type:   | No Drainfield        |
| Insp- Lift Pump in System:       | No  | Insp- Drainfield Size:   | na                   |
| Insp- Number of Bedrooms:        | 3   | Insp- Soil Verification: | #1:N/A #2:N/A #3:N/A |

#### Inspector Verified Setbacks

|                                      |      |  |    |
|--------------------------------------|------|--|----|
| Insp- Tank Dist to Road              | 10+  | Insp- Drainfield Dist to Road              | na |
| Insp- Tank Dist to Nearest Prop Line | 10+  | Insp- Drainfield Dist to Nearest Prop Line | na |
| Insp- Tank Dist to Nearest Structure | 50+  | Insp- Drainfield Dist to Nearest Structure | na |
| Insp- Tank Dist to Well              | 50+  | Insp- Drainfield Dist to Well              | na |
| Insp- Tank Dist to OHW               | 100+ | Insp- Drainfield Dist to OHW               | na |
| Insp- Tank Dist to Pond/Wetland      | na   | Insp- Drainfield Dist to Pond/Wetland      | na |
| Insp- Tank Dist to Pressure Line     | na   | Insp- Drainfield Dist to Pressure Line     | na |

#### Certificate of Compliance

(Yes) Certificate is hereby granted based upon the application, addendum from, plans, specifications and all other supporting data. With proper maintenance, this system can be expected to function satisfactory, however this is not a guarantee.

Certification Date: 08/01/2023

Zoning Office Signature:

Jeff Rusness - ISTS Inspector

\* Certificate of Compliance is not valid unless signed by a Registered Qualified Employee \*

# Field Review Form

Permit # SS2023-1694

## Property and Owner

Owner: SHIRLEY A JOHNSON

Parcel Number: 171279000

Site Address: 14546 TRADEWINDS RD

Secondary Parcel:

## Home Information

Does the structure contain any of the following elements?

Designer submitted

Inspector verified

Garbage disposal: No  
Dishwasher:  
Grinder pump:  
Lift pump in bsmt:

Garbage disposal? Y ☒ N  
Dishwasher? Y ☒ N  
Grinder pump? ☒ Y N  
Lift pump in basement? Y ☒ N

Number of bedrooms: 3

Review - Number of bedrooms: 3

Effluent screen

Effluent screen installed? Y ☒ N Mfr:

Alarm: Yes Type: float

Review - Alarm? ☒ Y N Type & Mfr: MANUAL float

Lift pump in system: No

Review - Lift pump in system? Y ☒ N Mfr:

## Component Information

Tank size: 2500

Review - Tank nbr: 1 size: 2500 Mfr: Brown/white

Drainfield type:

Review - Drainfield type: NA

Drainfield size: Full size -  
Reduced/warr. size -

Review - Drainfield status: none / installed / next spring  
Review - Drainfield size:

Absorption area size:

Review - Absorption area size:

Chamber type/num:  
Trench sqft/chamber -

Review - Chamber type:  
Review - Trench sqft/chamber: Num:

Drainfield rock depth:

Review - Rock depth:

## Soil Verification

Vertical separation verified

Boring #1:  
Boring #2: N/A  
Boring #3:

## Setback Verification

| Distance to...    | Designer submitted |            | Inspector verified |            |
|-------------------|--------------------|------------|--------------------|------------|
|                   | Tank               | Drainfield | Tank               | Drainfield |
| Road              | 10'                | na         | 10'                | NA         |
| Nearest prop line | 10'                | na         | 10'                |            |
| Nearest structure | 50'                | na         | 50+                |            |
| Well              | 50                 | na         | 50+                |            |
| OHW               | 200+               | na         | 100+               |            |
| Pond/Wetland      | na                 | na         | NA                 |            |
| Pressure line     | na                 | na         | N/A                |            |

Date System Installed: 5-30-2023

Installer:

Runner

Inspector:

Jack Runner

Sherley Johnson  
14546 Tradewinds Rd,  
171279000.

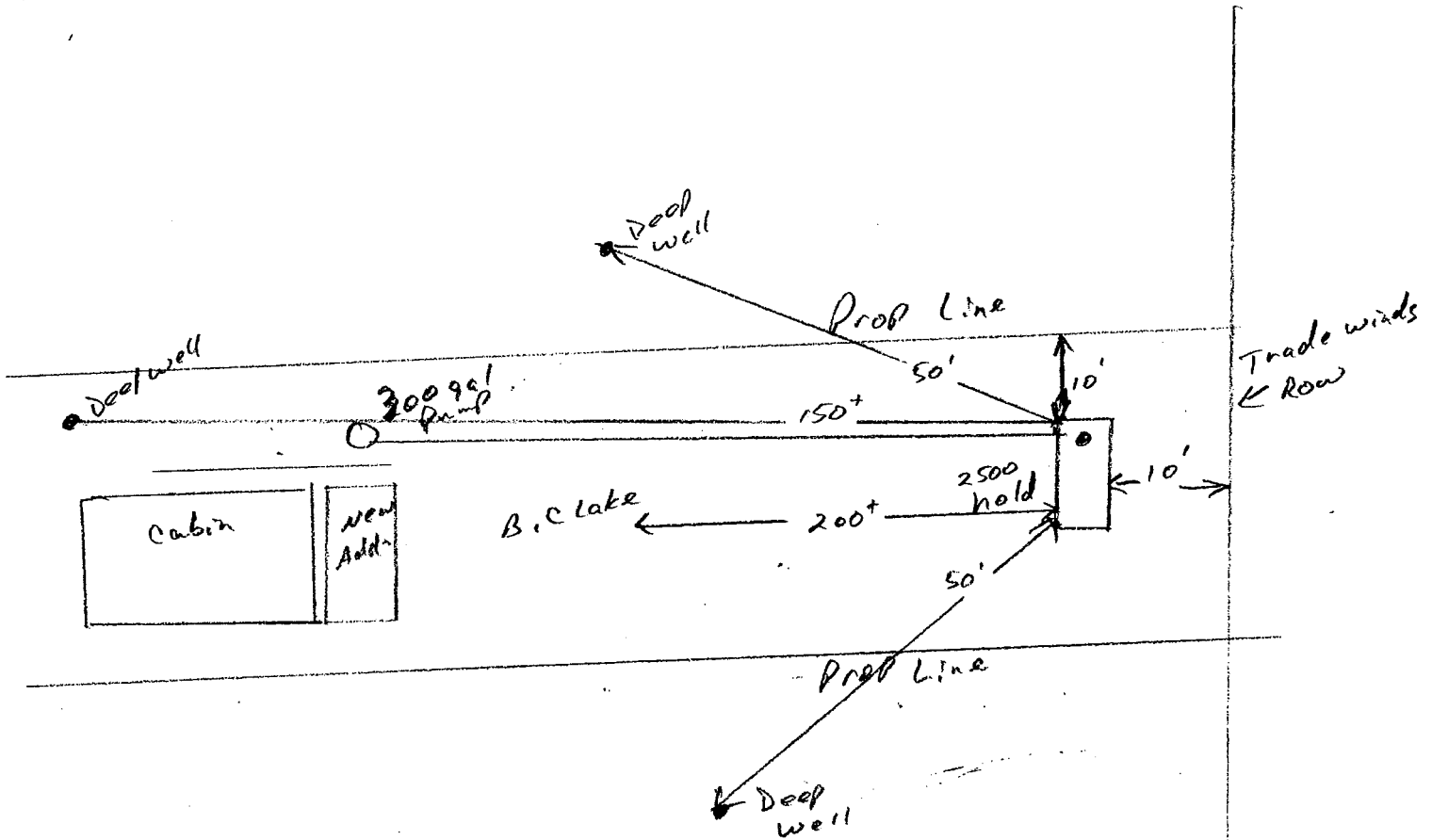

Plot C531  
R/S/M  
5-30-2022  
Rick Hemmer